



# THANE POLICE SCHOOL

Late Air Marshal Hemant Chitnis Marg, Kharkar Ali, Near Court Naka,  
Thane (W), Pin- 400601, Tel: 49766403

email : [tps@gaet.edu.in](mailto:tps@gaet.edu.in)

website: [www.tps.ac.in](http://www.tps.ac.in)

## School Information Manual 2025-2026

### Our vision and mission



*Within the tiny acorn  
lies the mighty oak.*

## Index

|   |                                       |    |
|---|---------------------------------------|----|
| 1 | About us -----                        | 3  |
| 2 | Floor at a glance-----                | 4  |
| 3 | School hours & visiting hours -----   | 5  |
| 4 | Prayer -----                          | 6  |
| 5 | National Anthem-----                  | 7  |
| 6 | School song -----                     | 8  |
| 7 | Academic year 2025 - 2026-----        | 9  |
| 8 | List of holidays for 2025 - 2026----- | 10 |

### More about us

|    |  |       |
|----|--|-------|
| 9  | Our objectives-----                      | 11    |
| 10 | Facilities in school -----               | 12    |
| 11 | Safety measures in school-----           | 13-14 |
| 12 | Our recommendations to parents-----      | 15-16 |
| 13 | Counselling Centre -----                 | 17    |
| 14 | Inside out -----                         | 18    |
| 15 | Instructions regarding school fees ----- | 19    |
| 16 | Fees & Payment Schedule -----            | 20-21 |
| 17 | Bus facility -----                       | 22-23 |
| 18 | Bus fees -----                           | 24    |
| 19 | Uniform -----                            | 25    |
| 20 | Rules for the students -----             | 26    |
| 21 | Admissions & withdrawals -----           | 27    |
| 22 | Open house dates -----                   | 28    |
| 23 | School events -----                      | 29    |



# About us

## THANE POLICE SCHOOL

is managed by,

## Goenka & Associates Educational Trust

Day to day affairs of running the School are being managed by the Principal assisted by appropriate staff under overall supervision of the School Committee comprising of 3 or 4 representatives of the Trust, the Principal and a representative of the teaching and non-teaching staff.

The School Building is spacious with all modern facilities and is designed to accommodate students of Nursery, Junior & Senior Kindergarten working in two shifts.

The motto of the school reads “विद्या विनयेन शोभते” which means **“Modesty adorns knowledge.”**

The School does not receive any Grant-in-Aid from the Government and the only source of income is the amount of fees collected from the students.

The Trust holds exemption u/s 80G of the Income Tax Act and is registered with the Charity Commissioner under Registration No. E8297 (BOM) dated 17- 8-1981 as a Public Charitable Trust with the object to establish and / or run educational institutions.

Any constructive suggestion from the parents whose children are being admitted to the Pre-School shall always be welcome. The Trust Office is housed in the Yashodham High School Building, Goregaon (E), Mumbai - 400 063, where such constructive suggestions can be recorded with the Trustee-in-charge.

The medium of instruction in the Pre-School is English with Nursery, Jr. KG & Sr. KG Classes. The Academic Year of the School begins in June.

# Floor at a glance

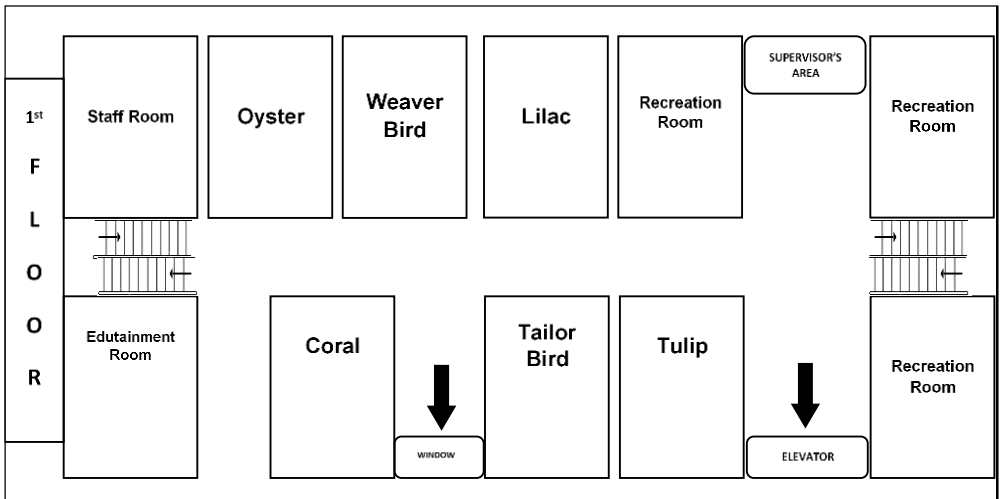



# School visiting hours

| <b>SCHOOL HOURS</b><br>(Monday to Friday)                  | <b>VISITING HOURS</b><br>(Monday to Friday)      |
|--|--|
| <b>MORNING GLORY (Batch I)</b><br>08:00 a.m. to 12:00 noon | <b>PRINCIPAL</b><br>10:30 a.m. to 12:30 p.m.     |
| <b>DAFFODILS (Batch II)</b><br>12:15 p.m. to 04:15 p.m.    | <b>SCHOOL OFFICE</b><br>08:30 a.m. to 12:30 p.m. |

**SATURDAY IS A HOLIDAY**

## Prayer

### गुरुस्तोत्रम्

गुरुर्ब्रम्हा गुरुर्विष्णूः गुरुर्देवो महेश्वरः।  
गुरुः साक्षात् परब्रम्ह तस्मै श्रीगुरवे नमः ॥

### सरस्वती वन्दना

या कुन्देन्दु तुषारहार धवला या शुभ्र वस्त्रावृता  
या वीणा वर दण्ड मण्डितकरा या श्वेतपद्मासना ।  
या ब्रम्हाच्युत शंकर प्रभृतिभिः देवैः सदा वन्दिता ।  
सा मां पातु सरस्वती भगवती निः शेष जाडयापहा॥

### गायत्री मन्त्रम्

ॐ भूर्भुवः स्वः तत्सवितुर्वरेण्यम् ।  
भर्गो देवस्य धीमहि धियो यो नः प्रचोदयात् ॥

# National Anthem

जन गण मन अधिनायक जय हे  
भारत भाग्य विधाता  
पंजाब सिन्ध गुजरात मराठा  
द्राविड उत्कल बंग  
विंध्य हिमाचल यमुना गंगा  
उच्छल जलधि तरंग  
तव शुभ नामे जागे  
तव शुभ आशीष मागे  
गाहे तव जयगाथा  
जन गण मंगलदायक  
जय हे भारत भाग्य विधाता  
जय हे, जय हे, जय हे  
जय जय जय जय हे





# School song

I have got the spirit of Thane Police School in me.  
T stands for talent,  
P for proficient,  
S for success,  
It's an amalgamation.

I have got the spirit of Thane Police School in me.

You give me wings to fly  
And the reason I smile  
You swell my heart with pride  
You will be cherished all my life.

Because I have got the spirit of Thane Police School in me.

You imbibe the values in me  
You propel the best out of me  
You mould my future, my destiny  
You are my identity.

Because I have got the spirit of Thane Police School in me.



# Academic Year 2025-2026

## TERM SCHEDULE

|  |                    |                                |           |
|--|--------------------|--------------------------------|-----------|
| <b><u>FIRST TERM</u></b>                 | Commences on       | 5 <sup>th</sup> June 2025      | Thursday  |
|  | Concludes on       | 17 <sup>th</sup> October 2025  | Friday    |
| <b><u>SECOND TERM</u></b>                | Commences on       | 3 <sup>rd</sup> November 2025  | Monday    |
|  | Concludes on       | 1 <sup>st</sup> May 2026       | Friday    |
| <b>VACATIONS</b>                         |                    |                                |           |
| <b><u>GANPATI FESTIVAL<br/>BREAK</u></b> | Begins on          | 27 <sup>th</sup> August 2025   | Wednesday |
|  | School Re-opens on | 1 <sup>st</sup> September 2025 | Monday    |
| <b><u>DIWALI<br/>VACATION</u></b>        | Begins on          | 20 <sup>th</sup> October 2025  | Monday    |
|  | School Re-opens on | 3 <sup>rd</sup> November 2025  | Monday    |
| <b><u>CHRISTMAS BREAK</u></b>            | Begins on          | 26 <sup>th</sup> December 2025 | Friday    |
|  | School Re-opens on | 2 <sup>nd</sup> January 2026   | Friday    |
| <b><u>SUMMER<br/>VACATION</u></b>        | Begins on          | 2 <sup>nd</sup> May 2026       | Saturday  |
|  | School Re-opens on | 4 <sup>th</sup> June 2026      | Thursday  |

# List of Holidays 2025-2026

| DATE   | MONTH     | YEAR | DAY       | OCCASION / FESTIVAL                 |
|--|-----------|------|-----------|-------------------------------------|
| 02 <sup>nd</sup>                             | JULY      | 2025 | WEDNESDAY | FOUNDER'S DAY                       |
| 15 <sup>th</sup>                             | AUGUST    | 2025 | FRIDAY    | INDEPENDENCE DAY                    |
| 27 <sup>th</sup>                             | AUGUST    | 2025 | WEDNESDAY | GANESH CHATURTHI                    |
| 5 <sup>th</sup>                              | SEPTEMBER | 2025 | FRIDAY    | EID – E – MILAD                     |
| 2 <sup>nd</sup>                              | OCTOBER   | 2025 | THURSDAY  | GANDHI JAYANTI, DUSSHERA            |
| 21 <sup>st</sup>                             | OCTOBER   | 2025 | TUESDAY   | DIWALI, LAKSHMI PUJA                |
| 22 <sup>nd</sup>                             | OCTOBER   | 2025 | WEDNESDAY | BALI PRATIPADA                      |
| 23 <sup>rd</sup>                             | OCTOBER   | 2025 | THURSDAY  | BHAU BEEJ                           |
| 5 <sup>th</sup>                              | NOVEMBER  | 2025 | WEDNESDAY | GURUNANAK JAYANTI                   |
| 25 <sup>th</sup>                             | DECEMBER  | 2025 | THURSDAY  | CHRISTMAS                           |
| 1 <sup>st</sup>                              | JANUARY   | 2026 | THURSDAY  | NEW-YEAR                            |
| 14 <sup>th</sup>                             | JANUARY   | 2026 | WEDNESDAY | MAKAR SANKRANTI                     |
| 26 <sup>th</sup>                             | JANUARY   | 2026 | MONDAY    | REPUBLIC DAY                        |
| 19 <sup>th</sup>                             | FEBRUARY  | 2026 | THURSDAY  | CHHATRAPATI SHIVAJI MAHARAJ JAYANTI |
| 4 <sup>th</sup>                              | MARCH     | 2026 | WEDNESDAY | HOLI                                |
| 19 <sup>th</sup>                             | MARCH     | 2026 | THURSDAY  | GUDI PADWA, RAMZAN EID              |
| 26 <sup>th</sup>                             | MARCH     | 2026 | THURSDAY  | RAM NAVMI                           |
| 31 <sup>st</sup>                             | MARCH     | 2026 | TUESDAY   | MAHAVIR JAYANTI                     |
| 3 <sup>rd</sup>                              | APRIL     | 2026 | FRIDAY    | GOOD FRIDAY                         |
| 14 <sup>th</sup>                             | APRIL     | 2026 | TUESDAY   | DR. AMBEDKAR JAYANTI                |
| 01 <sup>st</sup>                             | MAY       | 2026 | FRIDAY    | MAHARASHTRA DAY, BUDDHA POURNIMA    |
| <b>HOLIDAYS FALLING ON SATURDAY / SUNDAY</b> |           |      |           |                                     |
| 7 <sup>th</sup>                              | JUNE      | 2025 | SATURDAY  | BAKRI – EID                         |
| 6 <sup>th</sup>                              | JULY      | 2025 | SUNDAY    | MOHARRAM                            |
| 9 <sup>th</sup>                              | AUGUST    | 2025 | SATURDAY  | RAKSHA BANDHAN                      |
| 16 <sup>th</sup>                             | AUGUST    | 2025 | SATURDAY  | GOKULASHTAMI                        |
| 6 <sup>th</sup>                              | SEPTEMBER | 2025 | SATURDAY  | ANANT CHATURDASHI                   |
| 6 <sup>th</sup>                              | DECEMBER  | 2025 | SATURDAY  | Dr. AMBEDKAR'S MAHAPARINIRVAN DIWAS |
| 15 <sup>th</sup>                             | FEBRUARY  | 2026 | SUNDAY    | MAHASHIVRATRI                       |
| <b>NON INSTRUCTIONAL DAYS</b>                |           |      |           |                                     |
| 05 <sup>th</sup>                             | SEPTEMBER | 2025 | FRIDAY    | TEACHERS' DAY                       |
| 14 <sup>th</sup>                             | NOVEMBER  | 2025 | FRIDAY    | CHILDREN'S DAY                      |



# Our Objective

- To provide educational opportunities appropriate to the child's age.
- To cater to the individual needs of children, covering all domains of development like Language, Cognitive, Social, Emotional, Creative, Physical & Spiritual.
- To expose children to stimulating activities by providing interactive educational materials that will nurture their Audio-Visual perceptions; Linguistic, Mathematical and Logical skills; Interpersonal and Intrapersonal relations and Spatial abilities.
- To give every child opportunity to listen and speak, explore and experiment, observe and question, read and write.
- To encourage family interaction by holding informative sessions, involving parents, teachers and the Child Counsellor.
- To inculcate healthy habits and noble virtues.
- To groom children to grow up into well-adjusted members of the society, by giving ample opportunity to create, innovate and discover.
- To cultivate love & respect for their Country.



# Facilities in School

- Relaxed and unpressured atmosphere for utmost stimulation.
- Spacious well-planned, well-lit, well-ventilated aesthetically designed school building with a colourful interior and conducive and congenial learning atmosphere.
- Experienced, efficient, well-trained, caring and patient staff, who shall be mother substitutes.
- Appropriate teacher-pupil ratio.
- Highly individualized child-centered learning experiences.
- Environment rich in learning resources.
- Modern Edutainment material for the development of self confidence, language and expression.
- Abundant fascinating concrete play equipment for the over-all development of the child.
- Decentralized, open, flexible space divided into functional areas.
- A well-stocked class library, with open shelves, easily and independently accessible.
- Provision to handle educational equipment in a user-friendly atmosphere.
- A well-equipped Counselling and Guidance Centre with a team of Professionals are always available for guidance and help.
- Safe, clean, cool Aquaguard filtered drinking water.
- Nutritious, tasty snacks hygienically cooked & served.
- Circulars, Weekly Rhyme and Portion Sheets are sent to the parents through the EduSprint Pro App.
- Bus facility for safe and secure travel to and from school.

*(Interested parents may fill in the bus enrollment form and contact school office for further details.)*



# Safety measures in school

## NOTE THE SAFETY PRACTICES FOLLOWED IN SCHOOL

- Entry of visitors and parents coming for inquiry in the school is logged - clearly with time-in and time-out specified.
- For Visitors, Pass is given for entry and is handed back at the gate on exit.
- A parent has to produce the Parent I-card issued by the school, at the gate to enter the school premises.
- Gates are closed after students enter the premises at 8 a.m. sharp (Batch-I) and 12.15 p.m. sharp (Batch-II).
- Parents can visit only the Office area which is on the first floor of the School building.
- No permission will be granted to parents to visit or explore the classrooms except on the Open House days or during Class Projects.
- CCTV cameras are placed in strategic position on all the floors.
- Students are always accompanied by the class teacher.
- Attendance is marked immediately after prayer and also after any outdoor activity.
- Use of mobile phones / camera / video shooting is strictly prohibited in the school premises.

**Good touch-safe touch sessions are conducted by teachers for students through stories, role play and through audio visual shows.**

In case a child is hurt in school -

- a) First-aid is immediately administered.
- b) Parent is informed.
- c) In case of any emergency, the child is taken to Pramila Hospital.

**Parents who come to collect the bus students from the school need to fill in the Bus form which is signed by the Class Teacher before handing over the child to the parent.**



### **SAFETY RELATED TO SCHOOL STAFF:**

- All staff members have submitted police verification certificates.
- 16PF at the time of appointment.

### **SAFETY IN THE SCHOOL BUS**

- All staff members have submitted police verification certificates.
- 2 CCTV cameras in each bus.
- Presence of a female attendant in all the buses.
- Second driver with badge in every bus.
- Breath Analyzer to check the staff for alcohol consumption.
- Periodic sessions conducted for the staff on First aid & Bus maintenance.
- They are counselled on how to behave with parents / students.
- Traffic police conducts sessions on Traffic rules every year.

### **GENERAL SAFETY IN THE SCHOOL PREMISES.**

- The Safety Committee meets once a month.
- A Takraar Peti (Complaint Box) is placed near the school office which will be opened only in the presence of the Principal & Vigilant Committee members.
- Mock Drill exercise is carried out at regular intervals.
- Fire audit is done once a month.
- Aquaguard water is sent for testing periodically to government recognized labs.
- Underground water tanks are cleaned periodically.
- Fumigation of the entire building is done every Saturday.
- Pest control is done every month.
- The school terrace is always locked.



GAET  
TPS

## Our recommendation to parents

- Allow your child to enjoy his / her childhood.
- Spend quality time with your child - Observe, Listen and Communicate.
- Encourage your child to speak in English.
- Inculcate in your child the importance of personal hygiene. Cut and trim your child's hair and nails periodically.
- Send your child to school regularly on time in perfect and clean uniform.
- Encourage good, healthy and hygienic eating habits.
- Take prior appointment to meet the Principal or the teachers.
- Confidently discuss with the Teacher / Principal, any problem faced by your child in the school.
- Take an appointment immediately with the child counsellor, if you observe any change in his / her behaviour.
- Ensure that you attend every Open House and interact with the class teacher to know your child's progress.
- If your child is suffering from infectious conditions like viral fever, conjunctivitis, acute cough and cold, chicken-pox, mumps, etc, kindly refrain from sending him / her to school as it leads to rapid spread of infection. All parents are advised to take this as a moral responsibility in preventing the spread of infection among students as well as staff and care givers in school. Children suffering from any such infectious conditions will be allowed to attend school **only on producing the Medical Fitness Certificate** duly signed by a doctor.
- Any medicine to be orally administered to be given in writing.
- Take prior permission from the Principal, in case leave is essential.



Please send a written note conveying reason/s for the absence.

- Abstain from giving flowers or presents to teachers.
- To celebrate your child's birthday, you may donate a book to the school library.
- Do not send any kind of sweets for distribution.
- Notify immediately any change in address and / or telephone number.
- Create a home library and encourage your child to handle books independently.
- Minimise exposure to Digital Gadgets.
- Abstain from sending your child to a private tutor.
- Encourage your child to ask questions, research the answers together.
- Go through the school circulars sent from time to time carefully.
- Encourage your child to participate in the field trips and activities.
- Send the Consent Form when asked for, on time.
- Inform the class teacher in writing, with regard to any major ailment / allergy / surgery your child has / had or is suffering from.





# Counselling Centre

The Trust has set up a State of Art Counselling Centre to provide help in the area of mental health.

The Centre is being looked after by a team of Psychologists, Counsellors, Remedial Educators, Occupational, Speech & Language Enhancement Therapist and a Psychiatrist.

The Centre practices HYBRID of TRANS-DISCIPLINARY and INTEGRATED model for intervention. The services offered are:

## **Classroom Counselling and guidance**

## **Personal Safety Educational Programme Against Child Sexual Abuse Parenting Workshops**

- Psycho-Educational Assessment
- Individual & Parent Counselling and Guidance
- Remedial Education
- Occupational & Sensory Integration Therapy
- Speech, Language Enhancement & Communication Therapy
- Brain Gym
- Aptitude Testing & Career Guidance
- Art based therapy (ABT)
- Dance Movement Therapy
- Hobby Classes
- Support Group for Parents
- Psychiatric Consultation

*(Subsidised charges for these services)*



# Inside... Out

An HR venture & initiative by the GAET Counselling Centre, in the form of a personal enrichment programme for all teachers across GAET schools.

## **Contact for details and prior appointment:**

Goenka Counselling Centre: 49706639

Yashodham Counselling Centre: 40278215/ 16

Vasant Vihar Counselling Centre: 25420507

Thane Police School Counselling Centre: 8828090954

## **Office Timings:**

Monday to Friday: 10:00 a.m. to 6:00 pm.

1st, 3rd & 5th Saturday: 10:00 a.m. to 2:00 p.m.



## Instructions regarding school fees

- Term Fee must be paid in the month of June along with June month's Tuition Fee and in December along with Second Term Tuition Fee.  
Fees can be paid monthly, quarterly, half yearly or yearly only.
- Admission fee will be charged for admission in **Nursery and all new admissions.**
- Fees for the months of April and May must be paid along with March fees and this holds good even for those who wish to leave the School in April/ May.
- The delay of payment beyond 3 months renders a pupil liable to be struck off the roll.  
If the pupil is re-admitted the Admission Fee must be paid again.
- **If a student is to be withdrawn, one calendar months' notice should be given in writing by the Parent / Guardian to the Principal of the School to arrange for the refund of the balance of tuition fees.**  
In exceptional circumstances of withdrawal, one month's tuition fee in lieu of one calendar months' notice will have to be paid.  
Amount collected as Term Fee or Tuition Fee will not be refunded.
- Students whose fees are not paid will be considered as defaulters.
- Unless all dues are paid, the progress of the child will not be communicated to the parent. School Leaving Certificate will not be issued till all the outstanding dues from the student at the time of leaving the school are paid and clearance certificate from the concerned authority is obtained.
- Students who leave the School in the month previous to any vacation must pay the fees for the vacation.
- No deduction in fees will be allowed for vacations or for broken period of the month.
- Full month's fee will be payable if the student's name appears on the roll on the 1st day of the month.
- Admission fee will not be refunded even if the student, for any reason, leaves the school immediately after securing admission.



## Fees 2025-2026

School fees will be accepted by EDUSPRINT PRO App only.

(Monthly, Quarterly, Half yearly or Annually)

General Category

Fee Payment Schedule

Nursery, Jr. K.G. & Sr. K.G.

| MONTHS DUE   | AMOUNT                        | DUE DATE  |
|--|-------------------------------|---|
| <b>Fee payment schedule in case of quarterly payment:</b>                      |                               |   |
| I – Quarter<br>June 2025 to August 2025<br>(Tuition fee + I Term Fee)          | 7500 x 4 = Rs.<br>30,000/-    | Payable on or before<br>5th June 2025 by<br>EduSprint Pro App.                    |
| II – Quarter<br>September 2025 to November 2025<br>(Tuition fee)               | 7500 x 3 = Rs.<br>22,500/-    | Payable on or before<br>12th September 2025<br>(10 a.m.) by EduSprint<br>Pro App. |
| III – Quarter<br>December 2025 to February 2026<br>(Tuition fee + II Term Fee) | 7500 x 4 = Rs.<br>30,000/-    | Payable on or before<br>12th December 2025<br>(10 a.m.) by EduSprint<br>Pro App.  |
| IV – Quarter<br>March 2026 to May 2026<br>(Tuition fee)                        | 7500 x 3 = Rs.<br>22,500/-    | Payable on or before<br>12th March 2026<br>(10 a.m.) by EduSprint<br>Pro App.     |
| <b>Fee payment schedule in case of half yearly payment:</b>                    |                               |   |
| June 2025 to<br>November 2025<br>(Tuition + I Term Fee)                        | 7500 x 7 = Rs.<br>52,500/-    | Payable on or before<br>5th June 2025 by<br>EduSprint Pro App.                    |
| December 2025 to<br>May 2026<br>(Tuition Fee + II Term Fee)                    | 7500 x 7 = Rs.<br>52,500/-    | Payable on or before<br>12th December 2025<br>(10 a.m.) by EduSprint<br>Pro App.  |
| <b>Fee payment schedule in case of yearly payment:</b>                         |                               |   |
| June 2025 to May 2026 +<br>I Term Fee + II Term Fee                            | 7500 x 14 =<br>Rs. 1,05,000/- | Payable on or before<br>1st June 2025   |

**Note:** Admission fee of Rs 7500/- is applicable in case of new admission.

Payment made after the 12th of the due month after 10 a.m. shall be received with a surcharge of Rs. 200/- per month or part thereof.

Bus fees is applicable for those who are availing school bus service.



# Fees 2025-2026

School fees will be accepted by **EDUSPRINT PRO App** only.  
(Monthly, Quarterly, Half yearly or Annually)

**Police Category**  
**Fee Payment Schedule**  
**Nursery, Jr. K.G. & Sr. K.G.**

| MONTHS DUE   | AMOUNT                      | DUE DATE  |
|--|-----------------------------|---|
| <b>Fee payment schedule in case of quarterly payment:</b>                      |                             |   |
| I – Quarter<br>June 2025 to August 2025<br>(Tuition fee + I Term Fee)          | 2000 x 4 = Rs.<br>8000/-    | Payable on or before<br>5th June 2025 by<br>EduSprint Pro App.                    |
| II – Quarter<br>September 2025 to November 2025<br>(Tuition fee)               | 2000 x 3 = Rs.<br>6000/-    | Payable on or before<br>12th September 2025<br>(10 a.m.) by EduSprint<br>Pro App. |
| III – Quarter<br>December 2025 to February 2026<br>(Tuition fee + II Term Fee) | 2000 x 4 = Rs.<br>8000/-    | Payable on or before<br>12th December 2025<br>(10 a.m.) by EduSprint<br>Pro App.  |
| IV – Quarter<br>March 2026 to May 2026<br>(Tuition fee)                        | 2000 x 3 = Rs.<br>6000/-    | Payable on or before<br>12th March 2026<br>(10 a.m.) by EduSprint<br>Pro App.     |
| <b>Fee payment schedule in case of half yearly payment:</b>                    |                             |   |
| June 2025 to<br>November 2025<br>(Tuition + I Term Fee)                        | 2000 x 7 = Rs.<br>14,000/-  | Payable on or before<br>5th June 2025 by<br>EduSprint Pro App.                    |
| December 2025 to<br>May 2026<br>(Tuition Fee + II Term Fee)                    | 2000 x 7 = Rs.<br>14,000/-  | Payable on or before<br>12th December 2025<br>(10 a.m.) by EduSprint<br>Pro App.  |
| <b>Fee payment schedule in case of yearly payment:</b>                         |                             |   |
| June 2025 to May 2026 +<br>I Term Fee + II Term Fee                            | 2000 x 14 =<br>Rs. 28,000/- | Payable on or before<br>1st June 2025   |

**Note:** Admission fee of Rs 2000/- is applicable in case of new admission.

Payment made after the 12th of the due month after 10 a.m. shall be received with a surcharge of Rs. 100/- per month or part thereof.

Bus fees is applicable for those who are availing school bus service.



# Bus Facility

- The School provides bus service to the students of Thane Police School under the aegis of G.A.E.T.

## INSTRUCTIONS:

- The bus facility is extended to students only when there is an availability of seat and is offered at the Principal's discretion. This offer can be withdrawn any time.
- **Students will board and alight only at fixed bus stops.** Parents and children are requested not to ask the driver or attendant to stop the buses at unauthorized bus stops.
- Parents are not permitted to change the bus stops without prior permission. In case there is a change in the bus stop, the parents must inform the school in writing.
- Children must obey and must be courteous to the bus-in-charge. Children found misbehaving in the bus will not be allowed to continue availing the bus facility.
- **In the event of the child not being at the stop at the scheduled time the bus will proceed without the child.**

It will be the responsibility of the parent / guardian to reach the child to school. In the event of there being no one to receive the child at the stop of the return journey, the child will be brought to the school and the parents will have to collect their child from the school authorities on presentation of their identity card.

- If the parent doesn't want their ward to avail the bus facility for some reason on a particular day, the school must be informed about it in writing.
- In case of any grievance, parents must inform the school authorities in writing for appropriate action. Parents must not enter / board the school bus for any reason.

### IDENTITY CARD:

- Children using the bus facility need to wear an ID Card issued by the school which must have the bus number written on it.
- In case there is a change in the residential address the school office must be notified immediately and a fresh ID Card must be obtained.
- If the Bus ID card is lost a written application requesting a duplicate ID card must be submitted in the school office immediately. Collect the duplicate ID Card from the school office.
- Parents can track the school bus using the TRACKIFY APP.

### WITHDRAWAL:

- Parents must note that no refund will be made against bus fees paid.
- One-month advance notice in writing must be given by the parents to the School Office, in case they wish to discontinue the bus facility.  
(Applicable only if student is leaving school or changing residence.)  
Viz ....
- For withdrawal **after I term** duly filled Withdrawal Form must be submitted by **10th of October** to the school office.
- For withdrawal **after II term** duly filled Withdrawal Form must be submitted by **10th of April** to the school office.

### NOTE:

- Rs. 2500 is payable as **Admission Fee** (non - refundable) at the time of enrollment.
- Enrollment form can be obtained from the School office.
- No Bus child will be permitted to go home without submitting the permission letter.

# Bus Fees

**Bus fees will be accepted through EduSprint Pro app only.**

## ***Procedure for payment:***

- *Bus Fees will be charged for all the twelve months of the year.*
- Fees will be collected in two installments

| Installment | Period           | Payable   |
|-------------|------------------|---|
| I           | June to November | Payable in April 2025 through EduSprint Pro App. (latest by 15th May 2025)        |
| II          | December to May  | Payable in October 2025 through EduSprint Pro App. (latest by 15th November 2025) |

- **Students will not be allowed to avail the bus facility if the fee is not received as per the payment schedule mentioned above.**





GAET  
TPS

# Uniform

- School Identity Card must be worn on all days.
- Uniform and shoes other than the pattern recommended by the school will not be permitted.
- Students should not come to school, wearing, slippers or sports shoes.
- Girls must wear black elastic hair band. Those with long hair must tie two ponies or plaits.
- Hairstyle for boys: Crew cut (No fancy haircuts)
- Wearing of the following is not permitted:
  - i) Jewellery
  - ii) Cosmetics of any kind
  - iii) Fancy hair band and clips
  - iv) Nail paint

## **Monday - Wednesday - Friday**

Purple T-Shirt & Khaki pant.

Socks: Plain white and purple tipping.

Shoes: White velcro sneakers

## **Tuesday & Thursday**

Navy Blue T-Shirt & Khaki pant.

Socks: Plain white with navy blue tipping.

Shoes: White velcro sneakers.

Winter Uniform: Navy blue jacket.

**NOTE:** Students are expected to come in full uniform on all working days of the week.



# Rules for the students

## EXPECTED BEHAVIOUR:

- Treat everyone with respect and honesty.
- Arrive on time to School.
- Wear proper School Uniform.
- Wear the School Identity Card.
- Maintain good conduct, discipline and good behaviour in School Transport.
- Handle toys and library books with care.



# Admission and Withdrawals

- Registration for Admission will be done online.
- Announcement for registration will be notified through the school website.
- For online registrations log on to **www.gaet.edu.in**

## ELIGIBILITY FOR THE ACADEMIC YEAR 2025 – 2026

- Nursery - Children born between 1st April 2021 & 31st Dec 2022
- Admission will be granted to those who comply with the eligibility criteria.

No relaxation in age limit will be given.

## DOCUMENTS TO BE BROUGHT AT THE TIME OF VERIFICATION:

- Original Birth Certificate (for verification only)
- Photo copy of the birth certificate.
- Aadhar Card of the child.
- One passport size photograph of the child.
- 2 sets of stamp size recent photographs of both the parents and the child.
- Proof of residence
- **All withdrawals** from the school can be made only on the written request for the same giving one calendar months' notice or paying fees equivalent to one month in lieu of the notice period by the parent / guardian of the child to the Principal.
- Application for a leaving certificate, should be made by the parent / guardian.
- Signatures of both the parents is mandatory on the Application Form.

# Open house

|    |                 |   |
|----|-----------------|---|
| 1. | <b>Saturday</b> | <b>5th July, 2025</b>                             |
| 2. | <b>Saturday</b> | <b>2nd August, 2025</b>                           |
| 3. | <b>Saturday</b> | <b>20th September, 2025</b>                       |
| 4. | <b>Friday</b>   | <b>17th October, 2025</b>                         |
| 5. | <b>Saturday</b> | <b>29th November, 2025</b>                        |
| 6. | <b>Saturday</b> | <b>31st January, 2026</b>                         |
| 7. | <b>Saturday</b> | <b>21st March, 2026 (For Sr KG)</b>               |
| 8. | <b>Saturday</b> | <b>18th April, 2026 (For Nursery &amp; Jr KG)</b> |

**Note: Subject to change under unforeseen circumstances or Public Holidays.**

- Parents must carry the parent I-card on all open house days.
- Children must wear the Blue School Uniform in case they accompany the parent.



# School events

Celebrations

Grand day with Grand Parents

Fun - n – Fiesta

Edutainment

Children on stage

Camping in the school

Project

Edu sports

Outings

Field Trips



Speak to your children  
as if they are the wisest, kindest,  
most beautiful and magical humans  
on the Earth,  
for what they believe is  
what they will BECOME!